

Data sheet - Support roller STO 12TN X (cylindrical, with inner ring)

Designation	STO 12 X
Type	cylindrical
D [mm]	32
d [mm]	12
F, Fw * [mm max.]	16
B1 [mm]	12
B [mm]	11,8
d1 [mm]	22
r [mm]	0,3
Dynamic load Crw [N]	8900
Static load C0rw [N]	10100
Speed limit [min-1]	9000

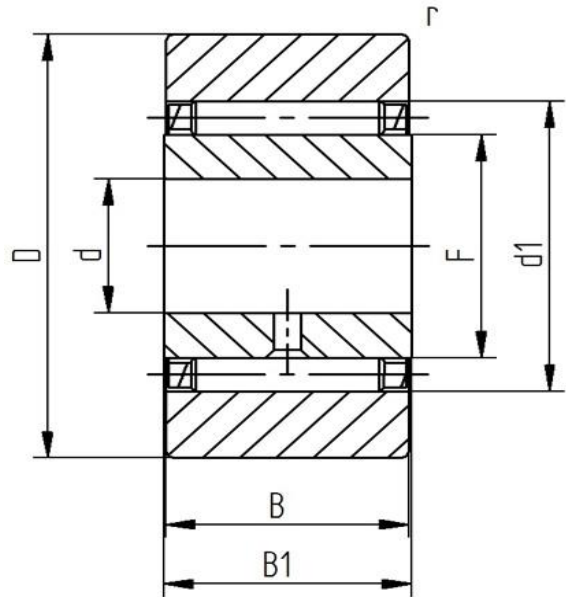

Every specification has been edited and verified carefully. STI Bearings GmbH assumes no liability for potential errors or incompleteness. Technical modifications are subject of changes.
 © 2020 by STI Bearings GmbH
 Reproduction, even excerpts, only with our approval.